



test yourself

Find the Area

Find the area of figure ABCD. At B and C, the lines are tangent to the circular curve with arc BC. Arc BC is subtended by an angle of exactly 63° at radius point X.. ■

For the solution to this problem (and much more), please visit our website at: www.amerisurv.com. Good luck!

Dr. Richard Elgin is semiretired, working part-time for Archer-Elgin Surveying and Engineering, LLC in Rolla, Missouri. He also is an Adjunct Professor of Civil Engineering at Missouri University of Science and Technology. Dick is a practitioner, professor, researcher and author.

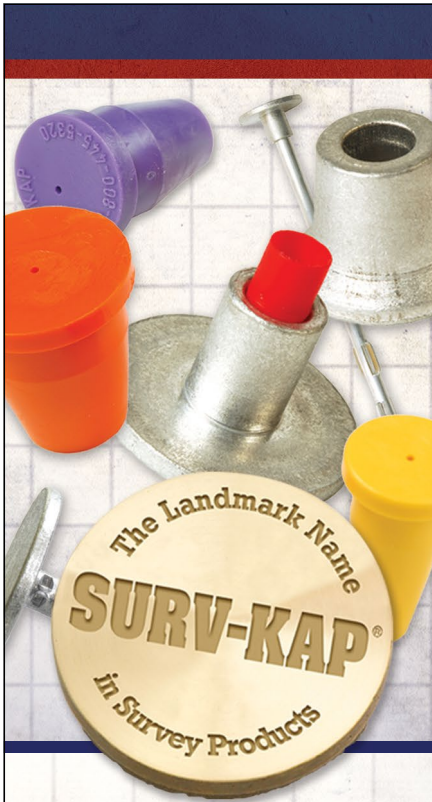
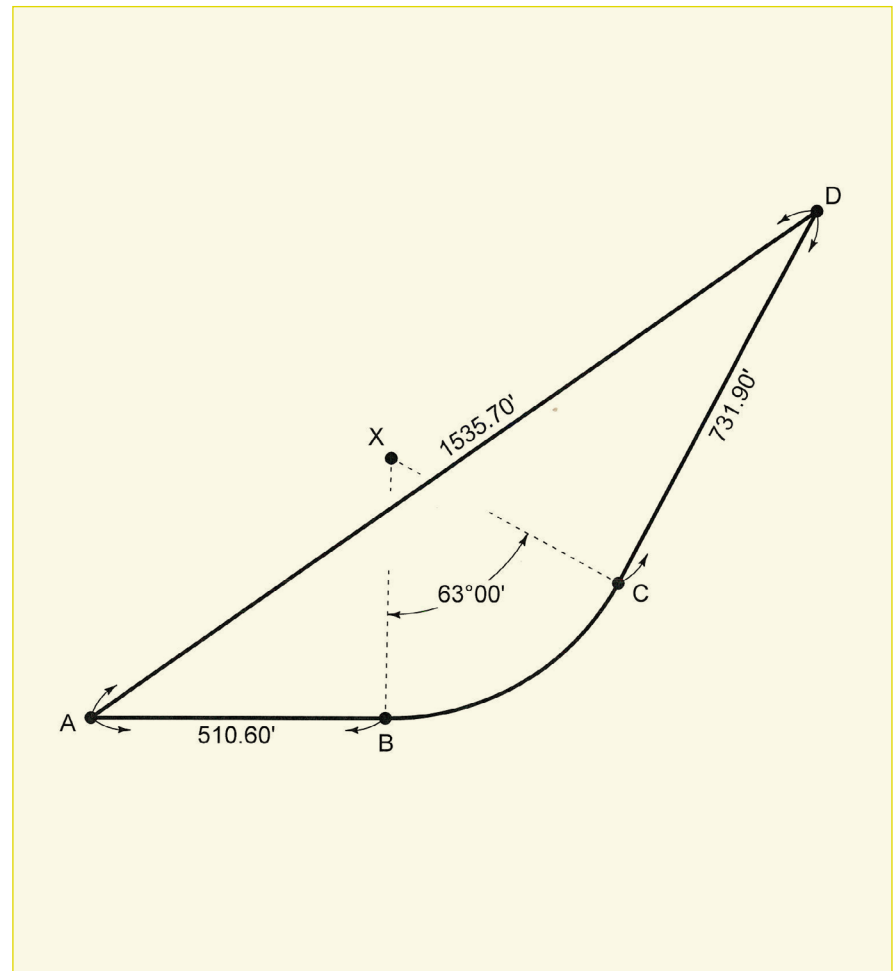

CUSTOMER SERVICE... we stake our reputation on it.

EASY ONLINE ORDERING!

Your Satisfaction, Guaranteed.

SURV-KAP

- SURVEY MARKERS
- CAPS
- ACCESSORIES

800-445-5320



SURV-KAP.COM